

Lecture Centre

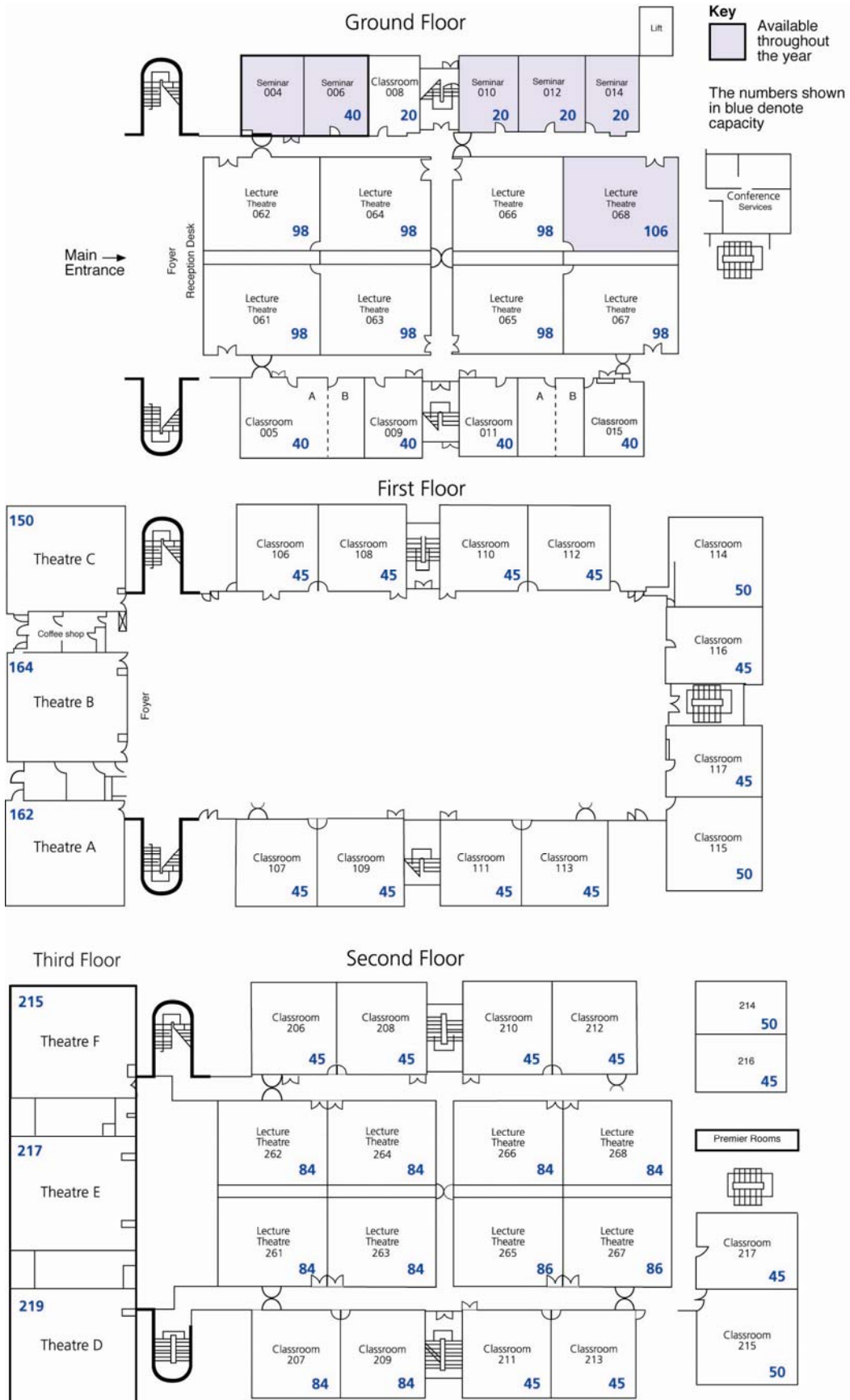

All year round rooms

| Lecture Centre Conference Rooms | Theatre | Seminar Rooms | |
|------------------------------------|-------------|---------------|-------------|
| Quantities | 1 x 98 Seat | 3 x 30 Seat | 1 x 50 Seat |
| Capacity | | | |
| Theatre | 98 | 30 | 50 |
| Boardroom | | 15 | 30 |
| Classroom | 98 | 20 | 40 |
| Technical | | | |
| Built in screen | Yes | Yes | Yes |
| Telephone | Yes | Yes | Yes |
| 13-amp Points | Yes | Yes | Yes |
| Blackout | Yes | Yes | Yes |
| Whiteboards | Yes | Yes | Yes |
| Internet Access | Yes | No | No |
| Natural Light | No | Yes | Yes |
| Tiered Seating | Yes | No | No |
| Flat Space | No | Yes | Yes |

Howell Centre

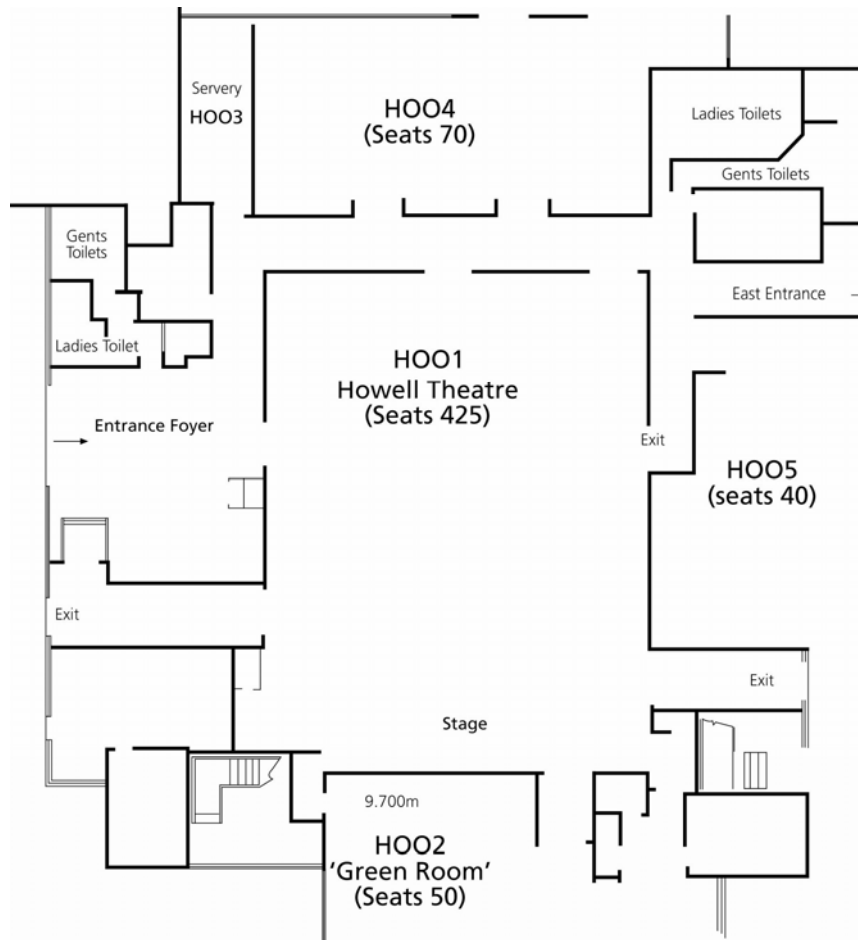

| Howell Centre | Theatre H001 | Seminar H002 Green Room | Seminar H004 | Seminar H005 |
|----------------------|--------------|-------------------------|--------------|--------------|
| Quantities | 1 | 1 | 1 | 1 |
| Capacity | | | | |
| Theatre | 425 | 10 | 100 | 80 |
| Boardroom | | 30 | 40 | 30 |
| Classroom | 425 | 40 | 90 | 70 |
| Technical | | | | |
| Built in Screen | Yes | Yes | Yes | Yes |
| 13-amp Points | Yes | Yes | Yes | Yes |
| Blackout | Yes | Yes | Yes | Yes |
| Whiteboards | Yes | Yes | Yes | Yes |
| Dimmers | Yes | - | - | - |
| Natural Light | - | Yes | Yes | Yes |
| Tiered Seating | Yes | - | - | - |
| Flat Room | - | Yes | Yes | Yes |
| Built in stage | Yes | - | - | - |
| Foyer Reception Area | Yes | Yes | Yes | Yes |
| Disabled Access | Yes | Yes | Yes | Yes |

Hamilton Suite

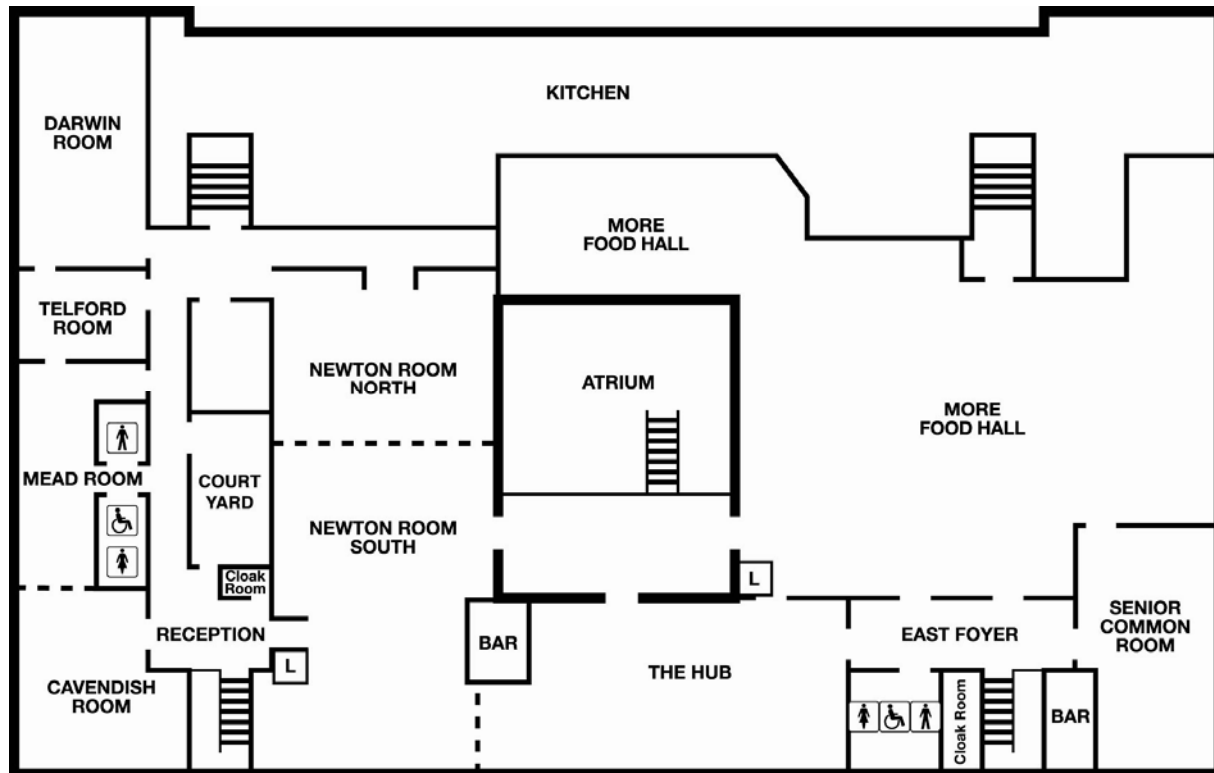

| Hospitality Rooms | Newton Room | Cavendish Room | Mead Room | Darwin Room | Telford Room |
|--------------------------------|-------------|----------------|-----------|-------------|--------------|
| Capacities | | | | | |
| Theatre | 250 | 50 | 50 | 120 | 40 |
| Boardroom | 46 | 26 | 22 | 36 | 28 |
| U Shape chairs only | 36 | 30 | 20 | 32 | 28 |
| U Shape tables & chairs | 32 | 22 | 20 | 32 | 22 |
| Banqueting | 220 | 60 | 40 | 100 | 30 |
| Technical Specification | | | | | |
| Flooring | Wooden | Carpet | Carpet | Carpet | Carpet |
| Folding Partition | Yes | Yes | Yes | No | No |
| Built in Screen | Yes | Yes | Yes | Yes | Yes |
| 13-amp points | Yes | Yes | Yes | Yes | Yes |
| Telephone | Yes | Yes | Yes | Yes | Yes |
| Blackout | Yes | Yes | Yes | Yes | Yes |
| Whiteboards | No | No | No | No | No |
| Dimmers | Yes | No | No | No | No |
| Natural Light | Yes | Yes | Yes | Yes | Yes |
| Internet Access | Yes | Yes | Yes | Yes | Yes |
| Disabled Access | Yes | Yes | Yes | Yes | Yes |
| Flat Room | Yes | Yes | Yes | Yes | Yes |